

Ideal for:
Tyre Service
Open Pit Mines & Quarries
Tyre Manufactures / Dealers
OEM / Workshops / Assembly Lines

Easy Gripper 3100-4T

Save
time
Improve
safety



Professional tools for handling of OTR/EM tyres up to 33.00R51

- Unique 3-point grip
- Precise rotation +/-25°
- 90° tilt, horizontal to vertical
- Tools for safe handling of tyre rings
- Integrated camera system for optimal view
- Prevent damage to tyres, rims & equipment
- Customization available



Experts in Tyre Handling Equipment



Easy Gripper

The Easy Gripper product range is designed to help tyre professionals in a multitude of conditions and situations. Implementing The Easy Gripper makes tyre handling faster and safer, while preventing damage to tyres, rims and equipment.

Capability

With a gripping range of Ø1.530 - 3.100 mm (60 - 122") and a lifting capacity of 4.000 kg (8.800 lbs) at a CoG of 650 mm (26"), the Easy Gripper 3100-4T handles large OTR/EM tyres and wheels up to 33.00R51. When handling full wheel assemblies as inside duals, the Gripper handles up to 27.00R49 tyres.



Open pit mines & quarries

Reduces down time and improves the safety for the tyre technicians. See also the tools for handling the rings, when mounting or demounting tyres.

Tyre manufacturers / dealers

For use in tyre production, warehouse, loading and unloading. Fast and safe handling – horizontal and vertical.



Tyre service

As stationary solution in open pit mines or as mobile solution mounted on forklift, front loader, or telehandler.

OEM

Handling of tyres and wheels from unloading to warehouse and assembly lines. Mounting of wheels with tilt, precise rotation and camera system.



Forklifts



The Easy Gripper 3100-4T with the 90° tilt module, is ideal for use on forklifts.

Front loaders and telehandlers



The Easy Gripper 3100-4T Compact without the tilt module is a good choice on front loaders and telehandlers, if the carrier can provide sufficient tilt.

Standard features

Unique and safe 3-point grip

Avoid accidents.
Avoid deformation of tyres.
Avoid damages to tyres, rims and equipment.

Integrated camera system with 2 cameras

For optimal view and for precise hub and bolt alignment.
With automatic IR function in insufficient light conditions.

Precise rotation +/-25°

90° tilt module, horizontal to vertical

LED working light

Customized attachment system

Optional accessories

Quick Shift System

Easy hook on and off.
Shift between Gripper and forks.

Easy shift of gripping pipes for various purposes

Telescopic pipes for long reach, to provide room for the tyre fitters and for dual tyre handling.

Tools for safe handling of tyre rings

To help tyre fitters with the hard and dangerous work.
Can easily be attached at the end of the gripping pipes.
Can push the tyre and can hold and place the rings.

Customization on request



Unique and safe 3-point grip



90° tilt - horizontal to vertical



Tools for safe handling of tyre rings

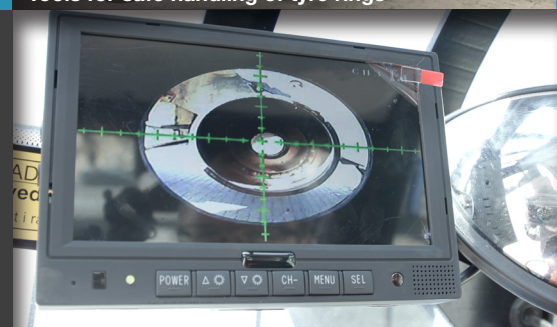

Integrated camera system for optimal view

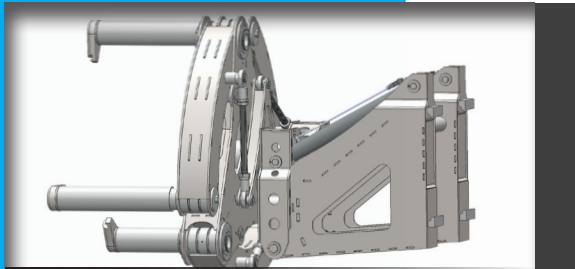

ISO/FEM/ITA Class 5 attachment

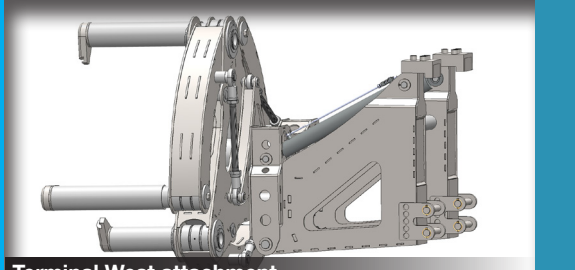

Terminal West attachment



Loader specific attachment

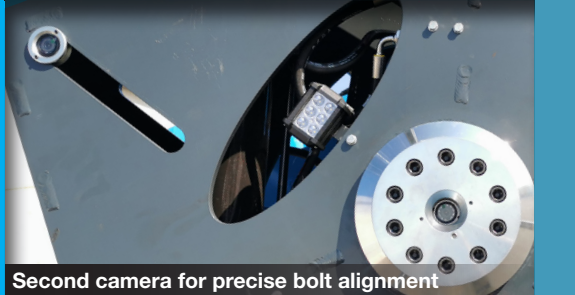

Second camera for precise bolt alignment

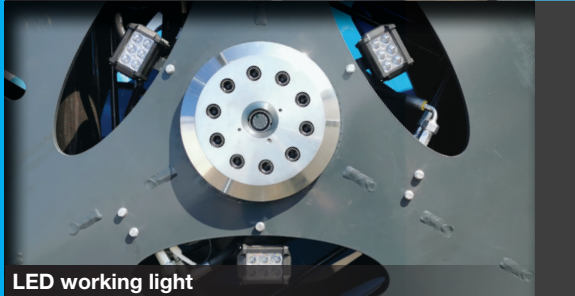

LED working light

Technical Specifications

Weight:	3.000 kg (6.600 lbs)
Lifting capacity:	4.000 kg (8.800 lbs) at C from B 650 mm
	2.600 kg (5.720 lbs) at D from B 1.300 mm
Tyre diameter:	1.530 - 3.100 mm (60 - 122")
Standard pipes:	Ø169 x 900 mm (6,7 x 35")
Telescopic pipes:	Ø180 x 1.280 -> 1.690 mm (7 x 50 -> 67")
Attachment:	ISO/FEM/ITA Class 5 / Terminal West / Loader specific

- A** CoG Gripper = 1.510 mm (59")
- B** Face of Gripper = 1.640 mm (65")
- C** CoG Load1 = 2.290 mm (90")
- D** CoG Load2 = 2.940 mm (116")

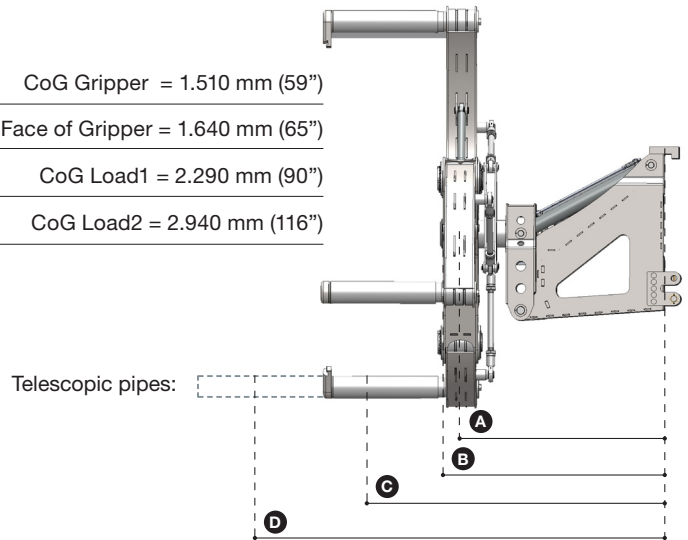

Technical Requirements of forklift or loader

Lifting capacity:	Individual calculation
Electrical supply:	12/24 V / min 10A
Hydraulic:	1 double acting hydraulic valve
Pressure min-max:	150 - 250 bar (2.175 - 3.626 psi)
Return pressure:	max. 10 bar (145 psi)
Flow:	max. 75 l/min. (19,8 gal/min.)

Authorized Dealer



+45 72 344 344
 info@justeasytools.dk
 www.justeasytools.com
 VAT no.: DK33644809

Just Easy Tools ApS
 Nupark 51
 DK-7500 Holstebro
 Denmark